

Glenfield

Water engineers to the world

Series 641/11 (5000) PN 16 Recoil Check Valve, 100mm - 500mm

Use
For water and neutral liquids to max 70°C

Tests
Hydraulic tests: Seat: 1.1 x PN Body: 1.5 x PN

Optional Extras
Limit/ Proximity switch By-pass
Alternative trim materials PN 25 Version

Applicable Standards
Flanges to BS EN 1092-2: PN16

Materials of Construction	
Description	Material
Body	Ductile Iron BS EN 1563 EN -GJS 500/7
Disc	Ductile Iron BS EN 1563 EN-GJS 500/7
Cover	Ductile Iron BS EN 1563 EN-GJS 500/7
Body Seat	Gunmetal BS EN 1982 CC491K
Disc Face	Gunmetal BS EN 1982 CC491K
Hinge Pin	Stainless Steel BS EN 10088 Gr. 1.4305
Fasteners	Zinc Plated Carbon Steel
Seals	EPDM
Coating DN100-300mm	Internal and external, electrostatically applied blue epoxy to WIS 4-52-01 Class B (250 microns)
Coating DN350-500mm	Internal and external blue two pack epoxy to WIS 4-52-01 Class B (250 microns)



Glenfield Valves Ltd, Glenfield Works, Queens Drive, Kilmarnock, Scotland, KA1 3XF

Tel: +44 (0) 1563 521150 Fax: +44 (0) 1563 545616 www.glenfield.co.uk

A member of the **AVR** group of companies



SPECIFICATIONS

Series 641/11 (5000) PN 16 Recoil Check Valve, 100mm - 500mm

Component List

- | | |
|--------------|--------------|
| 1. Body | 6. Hinge Pin |
| 2. Disc | 7. Fasteners |
| 3. Cover | 8. Seals |
| 4. Body Seat | 9. Air Plug |
| 5. Disc Face | |

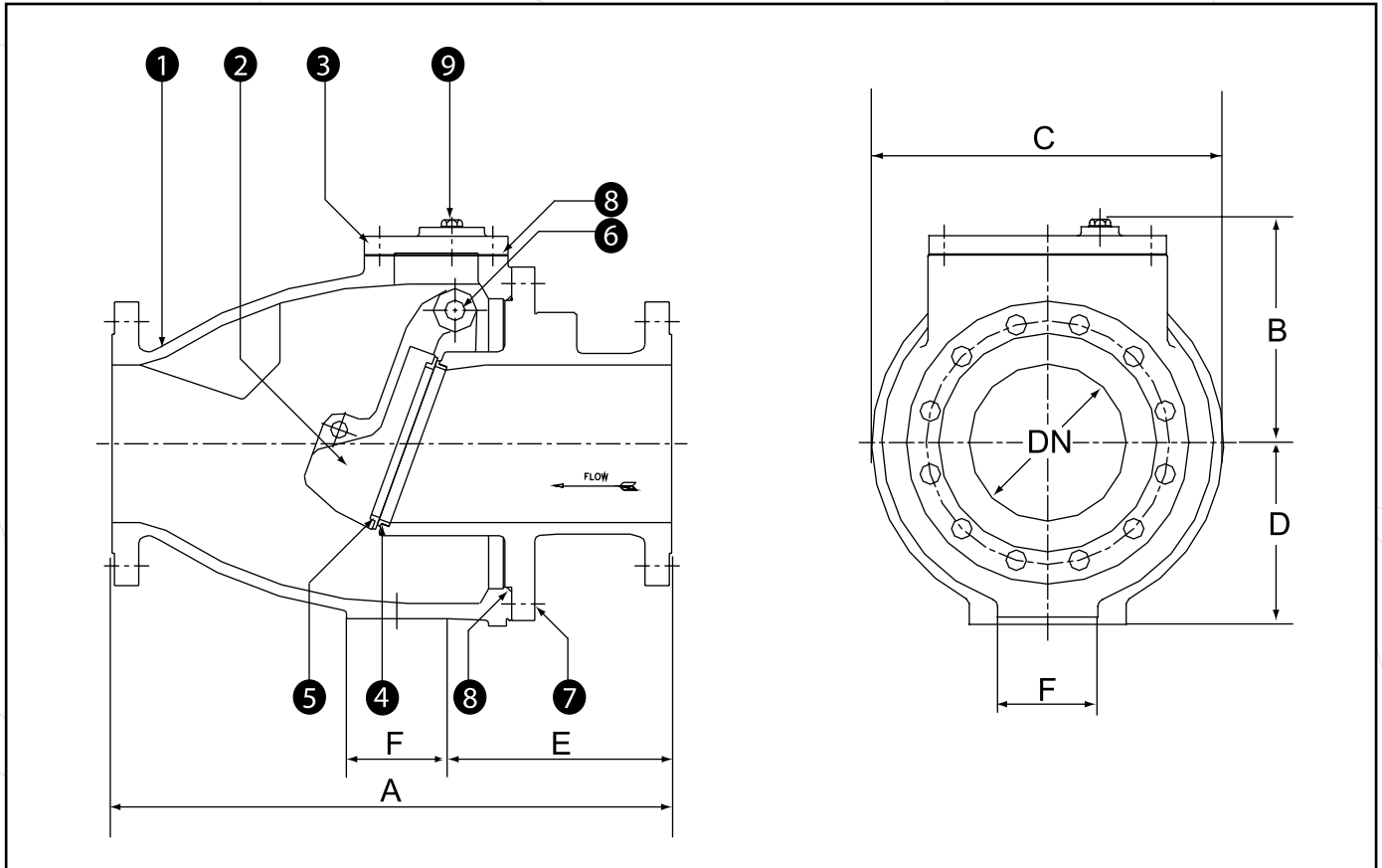

Dimensions & Weights

Ref. Nos.	DN	A	B	C	D	E	F	Bypass Dia	Weight kg
641-0100-11100000	100	495	210	311	159	202	100	19	81
641-0150-11100000	150	610	260	412	210	245	130	19	154
641-0200-11100000	200	762	343	533	273	296	150	19	290
641-0250-11100000	250	965	387	620	315	354	230	25	447
641-0300-11100000	300	1067	426	683	347	390	230	38	612
641-0350-11100000	350	1220	464	819	457	470	305	50	1038
641-0400-11100000	400	1220	464	819	457	470	305	50	1100
641-0450-11100000	450	1295	546	978	571	508	406	80	1564
641-0500-11100000	500	1473	635	1137	660	546	457	80	2240