

AVK UNDERGROUND FIRE HYDRANT, PN16

29/389

The Series 29/389 is a squat fire hydrant suitable for use with water and neutral liquids, to a maximum temperature of 70°C. Complies with requirements of BS 750:2006 and BS EN1074-2:2004 and EN 14339:2005, underground hydrants. Also to BS EN 1074-6 for potable (drinking) water.

Features:

- Fully maintainable.
- Ductile iron construction.
- 2½" London round thread outlet to BS 750.
- Exceeds flow requirements:
 - Kv = 92 minimum 2000l/min
 - Kv = 101 maximum 2200l/min
- Corrosion resistant construction, compliant with BS EN 1074-6 for disinfection products.
- Universal drilled inlet flange BS EN 1092:1997, BS 10 Table D/E.
- Inlet is of a proprietary type.
- Auto-frost drain valve as standard.
- Fixed, Draining stopper.
- Kite marked.
- Low weight design.
- WRAS approved.

Options:

- PN25 version.
- Loose stopper (refer to 29/188)
- Outlet options:
 - Stainless steel (standard) or Gunmetal to BS 750 round thread
 - Instantaneous (Morris)
 - Belfast
 - London "V" thread
 - Internal screwed Norwegian
 - Bayonet (Dublin)



The designs, materials and specifications shown are subject to change without notice due to our continuing programme of product development.

TESTS

Hydraulic test to BS 750
Seat: 1.1 x PN. Body: 1.5 x PN. Operating torque test.

APPLICABLE STANDARDS

Kite marked to BS 750:2006 Type 2c. Screwed -down type with screwed 2½" round thread outlet.
Inlet flange universally drilled to BS EN 1092-2 PN 10/16 and to BS 10 Table D/E.
Complies with Annex ZA of BS EN 14339 in respect of Construction Products Directive (CPD) 89/106/EEC.
WRAS approved.

SERVICE CONDITIONS

Maximum Working Pressure: 16 Bar.
Temperature Range: -10°C to +70°C.
Insulation essential for temperatures of 0°C and below.

MATERIALS OF CONSTRUCTION

No.	DESCRIPTION	MATERIAL
1	Body	Ductile Iron, BS EN 1563 EN-GJS-500-7.
2	Body/Bonnet Seal	NBR WRAS approved.
3	All Fastenings	Hex head screws, cap screws & washers Stainless Steel grade A4.
4	Stopper Assembly (fixed only)	Ductile Iron, BS EN 1563 EN-GJS-500-7, Encapsulated in EPDM with DZR brass wedge nut to BSEN12164 CW602N.
5	Bonnet	Ductile Iron, BS EN 1563 EN-GJS-500-7.
6	Thrust Collars	DZR brass, BS EN 12164, CW 602 N.
7	Gland Flange Assembly	Ductile iron, BS EN 1563 EN-GJS-500-7 with bush nylon 6.6 and 3 'O' Rings NBR WRAS approved.
8	Stem Cap	Ductile Iron, BS EN 1563 EN-GJS-500-7.
9	Stem	Stainless Steel, BS EN 10088 No.1.4404 (316)
10	Gland Flange Seal	NBR WRAS approved.
11	Dust Cap	Polyethylene.
12	Outlet	Stainless Steel to BS EN 10088 No. 1.4021.
13	Body/Outlet Seal	NBR WRAS approved.
14	Auto-frost Valve	Nylon 6.6 body and plunger with NBR WRAS approved 'O' rings and Stainless Steel spring to DIN 17224.
	Coating	Internal & external blue Epoxy applied to WIS-4-52-01 Class A.

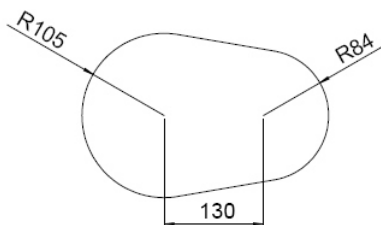
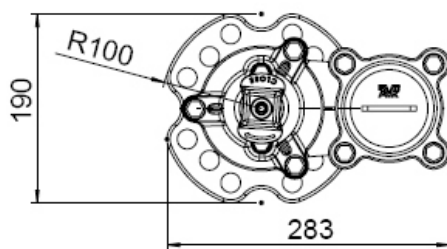
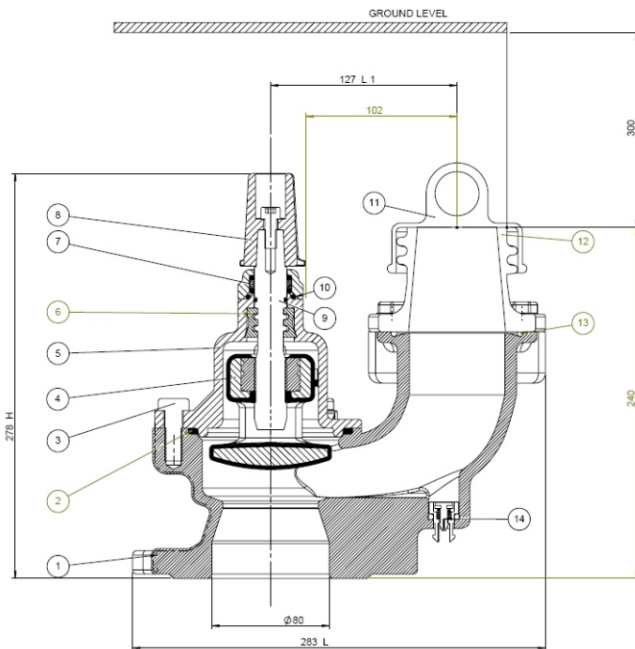

Minimum Clear Area of Surface Box & Cover

DIMENSIONS & WEIGHTS

Ref No.	DN	L	H	L1	Weight
With automatic Frost Valve	mm	mm	mm	mm	Kg
29-389-32112	80	283	278	127	12.5